

# NEOZED D0 fuse-links aM 400/440VAC

LOW VOLTAGE IEC FUSES

DIN LV FUSE-LINKS D0



The D0 fuse-system is installed in motor circuit protection, where fuse-links are accessible to non trained persons and can also be replaced by them.

The system is the most modern of the screw systems and designed for 400VAC/440VAC networks.

Type "aM" fuse-links are partial-range breaking capacity fuse-links, used to protect motor circuits as they are strongly current-limiting and have low power losses.

They limit and cut off short circuit currents from 6.3 times  $I_n$  up to their nominal breaking capacity.

## TECHNICAL DATA OVERVIEW

Voltage Range AC	400 ... 440 VAC
Ampere Range (A)	20 ... 35 A
Speed/Characteristic	aM
Product Size	D02

## FEATURES & BENEFITS

- Insulated body suitable for high mechanical and thermal impacts
- Top and bottom contacts made of nickel plated or silver plated copper alloy
- Safe cut-off short circuits due to special design of fuse element
- Clear indication of operation condition due to coloured indicator on top contact
- Low power dissipation
- Optimized size
- Resistant to aging

## APPLICATIONS

- Motor circuit protection

## STANDARDS

- DIN VDE 0636-3



# NEOZED D0 fuse-links aM 400/440VAC

## PRODUCT RANGE



D02AM44V20

### Size D02 (E18) aM

Catalog number	Item number	Rated voltage AC (IEC)	Rated current $I_n$	Colour	Power dissipation at $I_n$	Utilisation category	Weight	Package
D02AM44V20	H211607	440 V	20 A	blue	2.5 W	aM	13.2 g	10
D02AM44V25	F212640	440 V	25 A	yellow	3 W	aM	13.2 g	10
D02AM44V35	J213655	440 V	35 A	black	4 W	aM	13.2 g	10

## TIME CURRENT CHARACTERISTIC CURVES

### NEOZED D0 fuse-links aM 400/440VAC

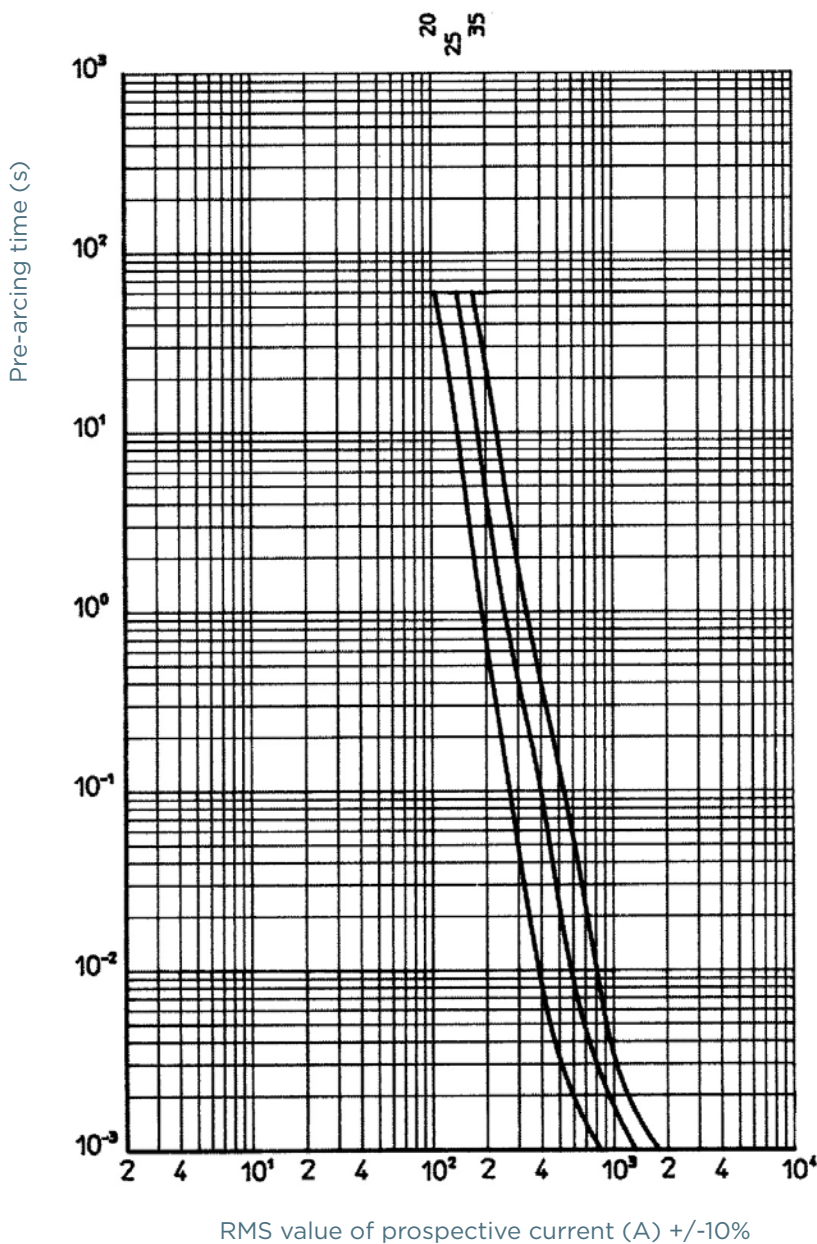

# NEOZED D0 fuse-links aM 400/440VAC

## CUT-OFF CURRENT CHARACTERISTIC

NEOZED D0 fuse-links aM 400/440VAC

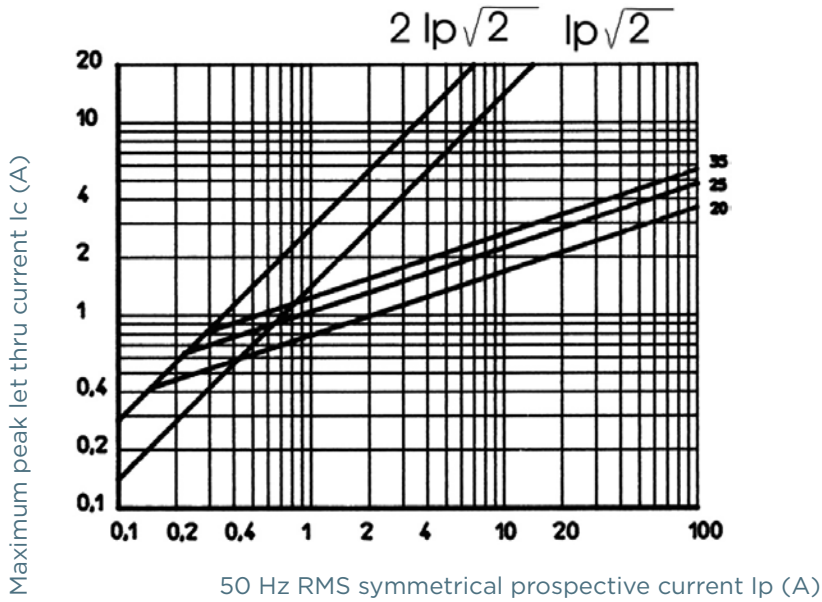

## DIMENSIONS

### NEOZED Fuse-Links

Size	a	b
D02	36 mm	15 mm

Dimensions in mm

### NEOZED Screw Caps

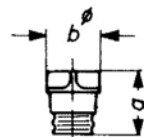

Article Number	a	b
01714.000000	29,5	23
01715.000000	29,5	23
01710.000000	31	25
01711.000000	31	25
01712.000000	37	40

Dimensions in mm

### NEOZED Adapter Inserts

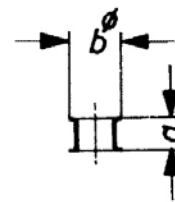

Article Number	a	b
01705.000000	10	12
01706.000000	10	16
01707.000000	10	27

Dimensions in mm

# NEOZED D0 fuse-links aM 400/440VAC

## ACCESSORIES



01715.000200



11715.000220

### D0 screw caps 400V AC synthetic

Catalog number	Item number	Weight	Description	Weight	Package
01715.000200	P211981	12.6 g	D02, E18, 63A, with testing hole	11.6 g	20
11715.000220	S214537	12.4 g	D02, E18, 63A, with sealing and testing hole	11.6 g	20
01715.000000	L206435	12.7 g	D02, E18, 63A, without testing hole	12 g	20



01715.000000

### D0 screw caps 400/440 VAC, 250 V DC porcelain, with removal grips



01711.000200

Catalog number	Item number	Weight	Description	Weight	Package
01711.000200	T215044	18.6 g	D02, E18, 63A, with testing hole	18.5 g	20

### D0 cartridge ring adapter inserts D02 E18



01706.020000



01706.025000

Catalog number	Item number	Weight	Description	Weight	Package
01706.020000	S200668	0.8 g	20A, blue	0.5 g	50
01706.025000	R213524	0.7 g	25A, yellow	0.6 g	50
01706.035000	J216070	0.7 g	35A, black	0.5 g	50



01706.035000

### Locking devices

Catalog number	Item number	Weight	Description	Weight	Package
01715.800000	R214582	38 g	Locking cap for D02 E18 fuse-bases for authorized personal only (EVU)	14 g	5
01715.810000	Y215094	16.6 g	Locking cap for D02 E18 fuse-bases	13.7 g	5

MERSEN reserves the right to change, update or correct, without notice, any information contained in this datasheet.

# NEOZED D0 fuse-links aM 400/440VAC

## ACCESSORIES



01707.000000

### Adapter inserts

Catalog number	Item number	Weight	Description	Weight	Package
01707.000000	T211985	16.9 g	Adapter (space holder) for Size D02 fuse-links in Size D03 bases	17.4 g	30
01709.000000	P214028	1.7 g	Adapter for Size D02 fuse-links in Size D03 bases	1.3 g	25